

NOTE:
WETLANDS AREA IS INCLUDED IN THE LOT ACREAGE PROVIDED ON LAYOUT.

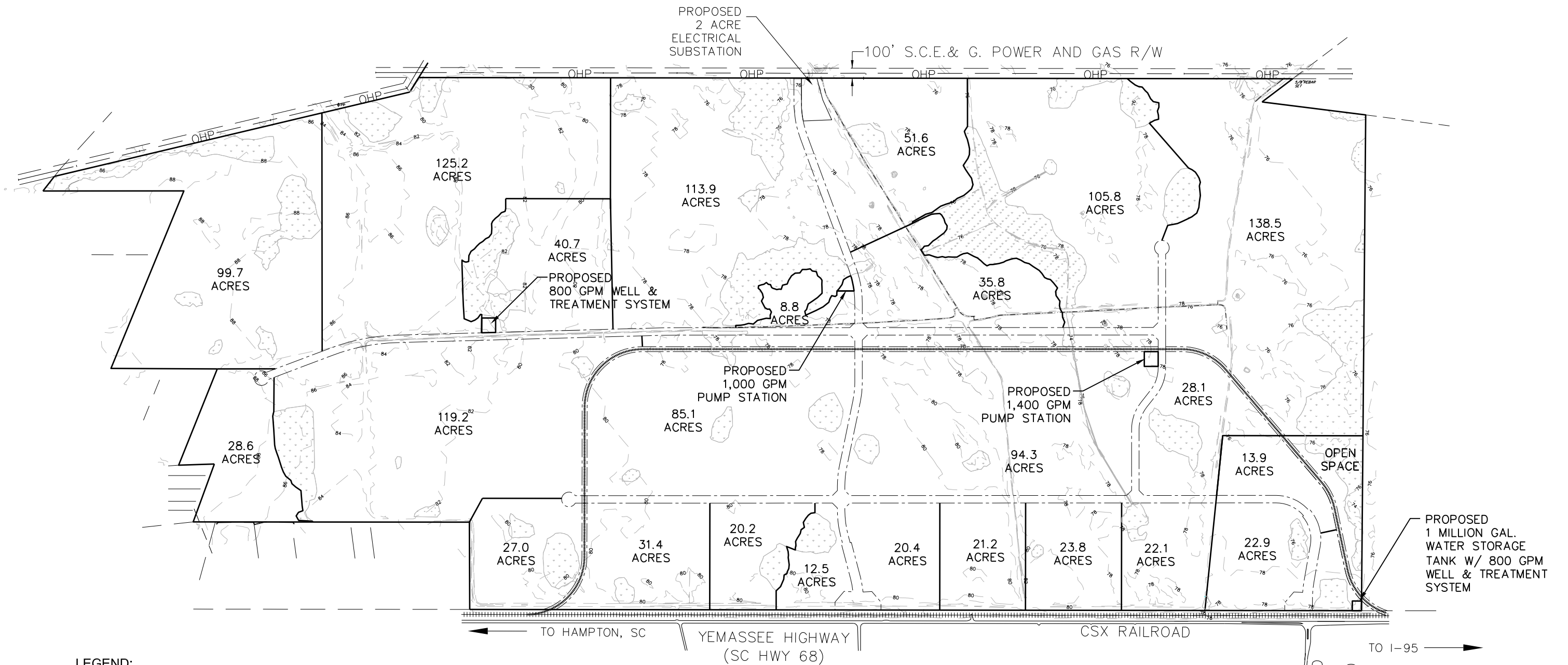

LEGEND:

- PROPERTY LINE
- - - 58 - - - EXISTING 2' CONTOURS
- - - 60 - - - EXISTING 10' CONTOURS
- EXISTING EDGE OF PAVEMENT
- - - - - PROPOSED ROAD & RAILROAD RIGHT-OF-WAY
- ===== EXISTING RAILROAD
- ===== PROPOSED RAILROAD
- - - - - POWER LINE EASMENT
- OHP ——— OVERHEAD POWER LINE
- [Stippled Area] WETLANDS
- - - - - JURISDICTIONAL TRIBUTARY

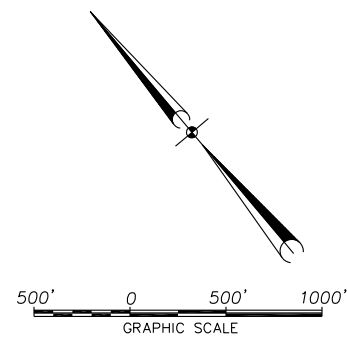

LOWCOUNTRY
REGIONAL
INDUSTRIAL PARK



OVERALL SITE LAYOUT
SOUTHERN CAROLINA COMMERCE PARK
in
HAMPTON COUNTY
for
MEADWESTVACO



DATE: MAR. 2010

SCALE: 1"=1000'

JOB #: 09272

SHEET 1 OF 1



N:\Projects\09272\09272_01_Site Cert Exhibits\exhibit J (3-1-10).dwg 3/8/2010 8:57:43 AM EST